

# S3 RELAY

## SHORI

### ◆ Features

- Low cost miniature PCB cube relay.
- General purpose application.
- 15A 24VDC, 15A 120VAC ratings.
- SPNO, SPNC, SPDT and sealed flux free & sealed Washable type are available.



### ◆ Coil Data [at 20°C]

- Standard Type

Rated voltage ( V )	Coil Resistance ±10% (Ω)	Rated Current ±10% (mA)	Pick up Voltage (Max)	Drop out Voltage (Min)	Max continuous Voltage	Power consumption At rated Voltage
3	25	120	75% of rated voltage	10% of rated voltage	130% Max of Rated voltage	Approx.0.36W
5	70	72				
6	100	60				
9	225	40				
12	400	30				
24	1600	15				
48	6400	7.5				

- High sensitivity Type

Rated voltage ( V )	Coil Resistance ±10% (Ω)	Rated Current ±10% (mA)	Pick up Voltage (Max)	Drop out Voltage (Min)	Max continuous Voltage	Power consumption At rated Voltage
3	37.5	120	75% of rated voltage	10% of rated voltage	130% Max of Rated voltage	Approx.0.24W
5	104.2	72				
6	150	60				
9	337.5	40				
12	600	30				
24	2400	15				
48	9600	7.5				

### ◆ Contact Rating

Resistive load	1C:5A 240VAC , 10A 24VDC 1A/1B :15A 120VAC, 16A 125VAC, 15A 24VDC
----------------	---

### ◆ Type List

Terminal style	Contact form	Designation(provided with)	
		Sealed type	Sealed type washable
PCB terminal	1A (SPNO)	S3-12-A	S3-12-AS
	1B (SPNC)	S3-12-B	S3-12-BS
	1C(SPDT)	S3-12	S3-12-CS

### ◆ Ordering information

S3 - 12 B - A S  
1 2 3 4

1. S3 -- Basic series designation

3. A -- Form A, normally open (SPNO)

B -- Form B, normally closed (SPNC)

Blank -- Form C, double-throw (SPDT)

2. 12 -- Coil Voltage (3V~48V)

4. S -- Sealed type washable

B -- High sensitivity Type

Blank -- Sealed type

### ◆ Specification

Contact material	Ag Alloy	
Contact resistance	100 mΩ Max	
Operate time	10 ms Max	
Release time	5 ms Max	
Insulation resistance	100 MΩ Min. (DC 500V)	
Dielectric strength	Between open contact : AC 500V ,50/60Hz 1 min.	
	Between contact and coil : AC 1500V, 50/60Hz 1 min.	
Vibration resistance	Operating extremes	10~50Hz, amplitude 1.5 mm
	Damage limits	10~50Hz, amplitude 1.5 mm
Shock resistance	Operating extremes	10G
	Damage limits	100G
Life expectancy	Mechanical	10,000,000 operations (frequency 18,000 operations/hr)
	Electrical	100,000 operations (frequency 1,200 operations/hr)
Operating ambient temperature	-30~+55°C (no freezing)	
Weight	Approx.9.5 g	

# S3 RELAY

## SHORI

### ◆ Safety Approval

Certified	UL/CUL	TUV
File No.	E188091	R9754312

### ◆ Safety Approval Rating

UL/CUL		TUV
1A/1B	15A 120VAC 16A 125VAC 15A 24VDC 5A/125VAC Tungsten	5A 240VAC 10A 24VDC
1C	10A 120VAC 10A 24VDC	

### ◆ Outline dimensions



### ◆ Wiring Diagram

BOTTOM VIEW

1A

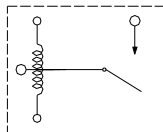

1B

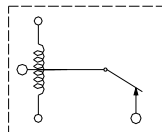

1C

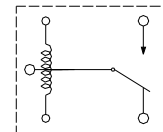

### ◆ PC BOARD LAYOUT

BOTTOM VIEW

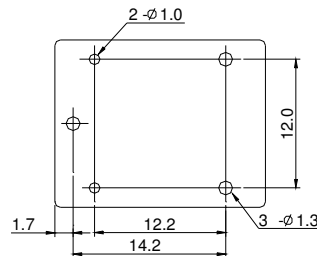

◆ Engineering Data

